

K.O. LASTOVO MBR 316717
PREDJEL: SVETI ANTUN-ZDRUJELO
KAT. PLAN BR. 19,

SKICA IZMJERE
M 1:500
LIST 3

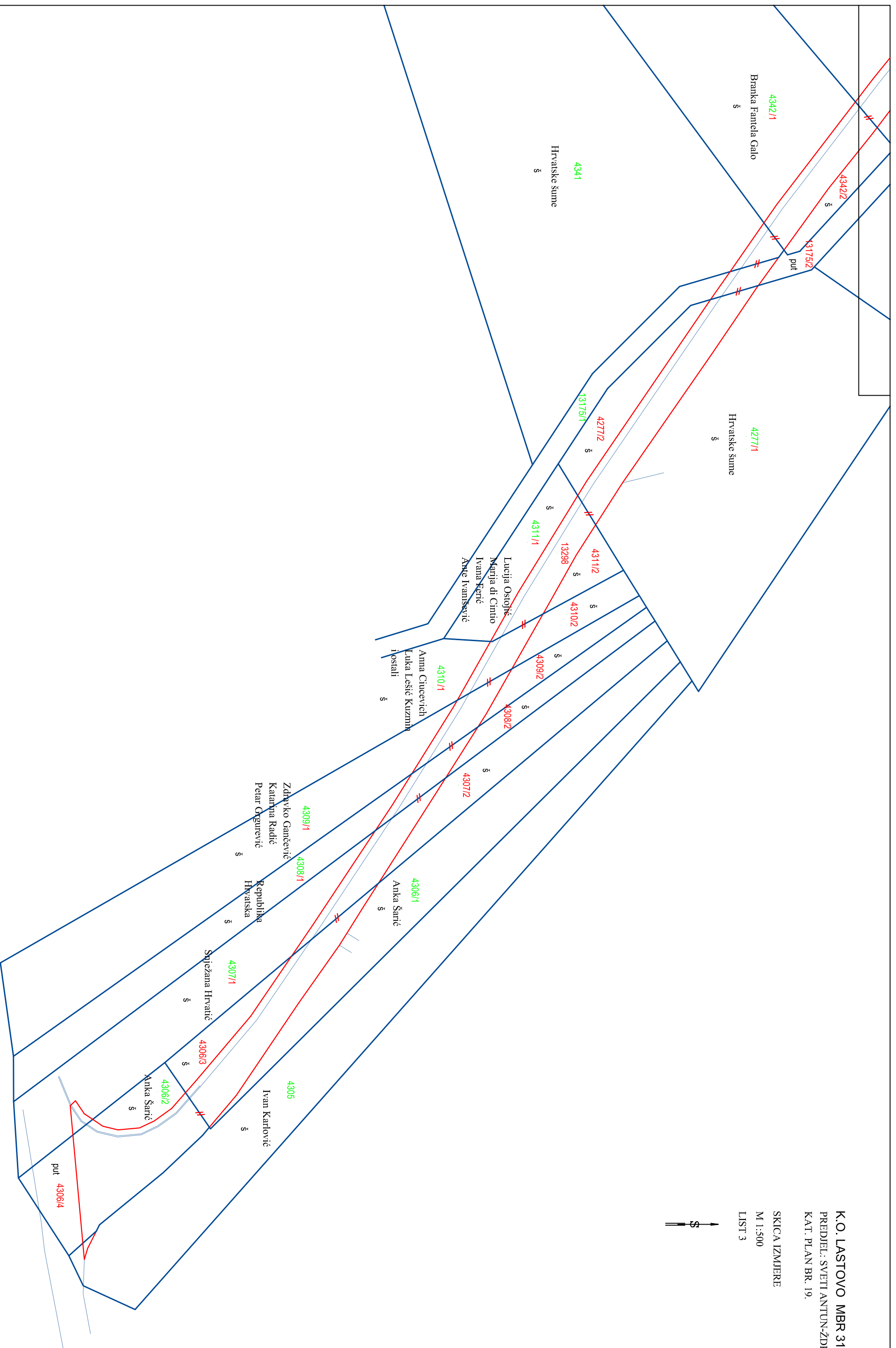
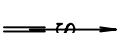

Izradio: Anton Bačić ing. geod.
U Blatu, 06.09.2023.

Ovlašteni inženjer geodezije:
Mišo Biliš dipl. ing. geod.